

UN PROJET DU POUR-CENT CULTUREL MIGROS  
EN PARTENARIAT AVEC LA VILLE DE GENEVE

# BUREAU CULTUREL

GENEVE

RUE DE BERNE 63, 1201 GENEVE

+41 22 732 72 01

GENEVE@BUREAUCULTUREL.CH

BUREAUCULTUREL.CH

Z-Finder Pro Zacuto

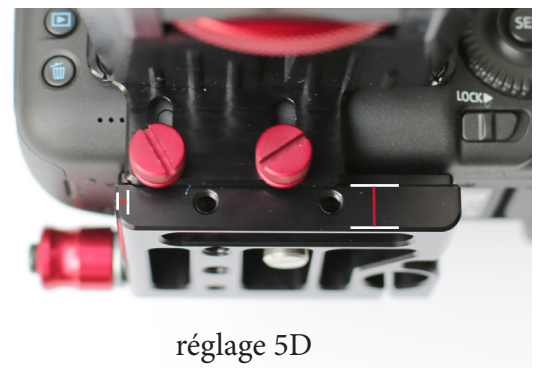

tournevis cruciforme

sac en toile



# Operating your Z-Finder Pro

## 1 Attach frame to Gorilla Plate

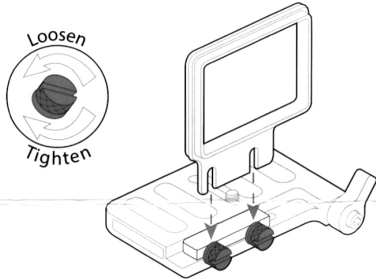

Press and hold frame against LCD and attach to camera with 1/4"-20 screw

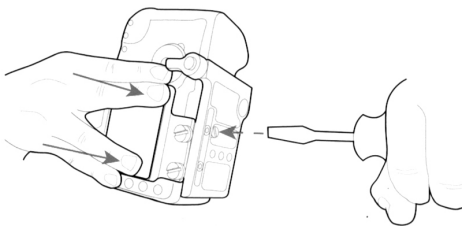

## 2 Center frame on camera LCD

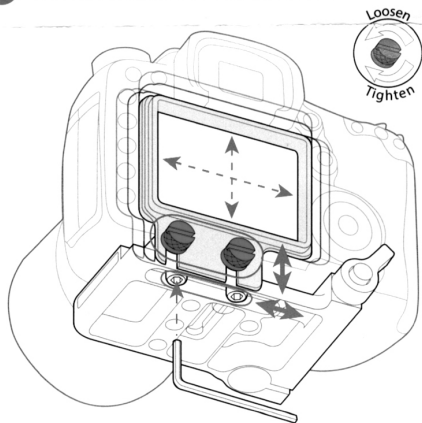

## 3 Rotate eyecup for desired position and attach Z-Finder to frame

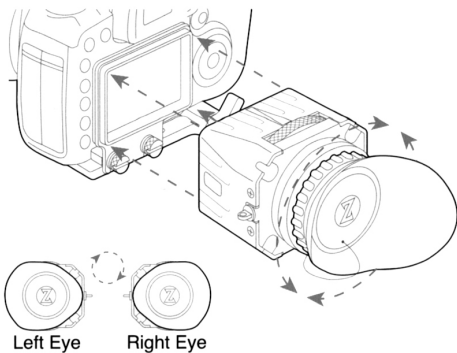

## Included Parts:

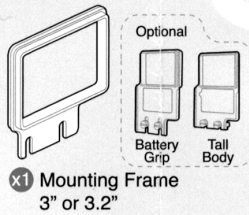
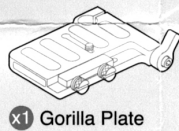
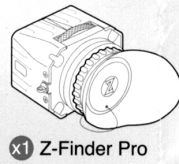

## Features:

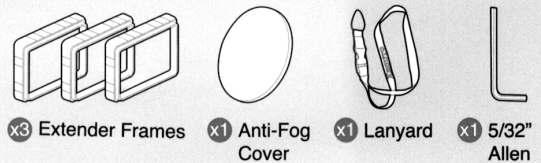
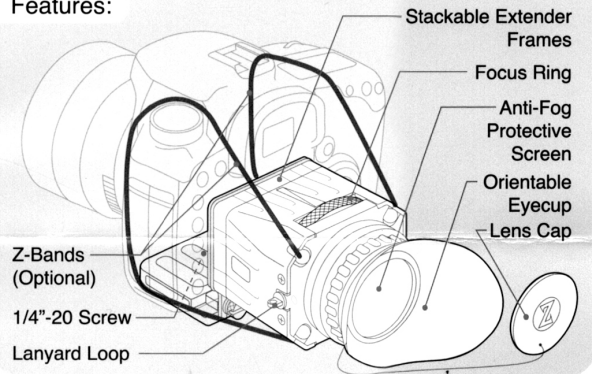

## 4 Focus the Z-Finder (Use letters in menu screens to focus on)

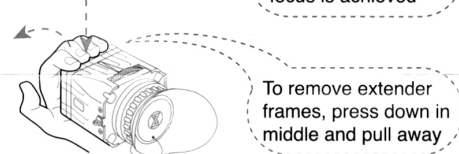
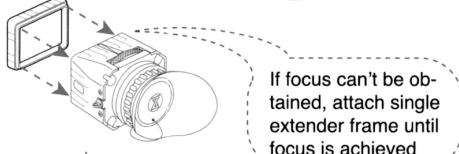
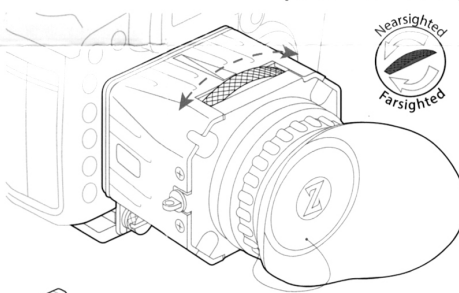

## 5 Install lanyard for protection

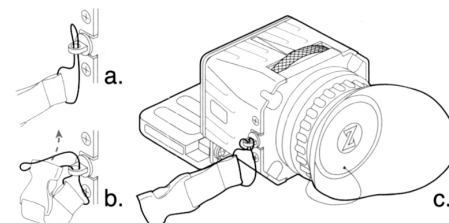

## Installation of Anti-Fog Cover

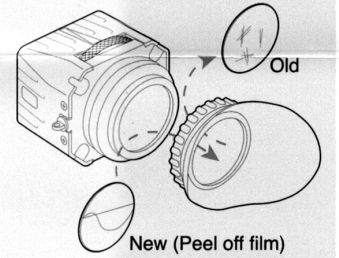

## ⚠ Precautions

The anti-fog protective covers naturally have a tackier surface than standard lenses and thus need to be cleaned differently. **Do not** wipe anti-fog protective cover with a dry lens cloth or tissue. Use a micro fiber lens cloth or Kim Wipe type tissue **and** soak with water. Wipe the cover then let air dry.

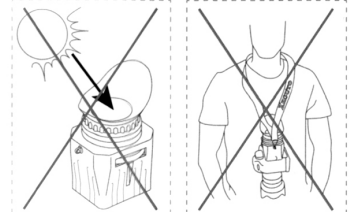

For more information, watch our tutorial video at Zacuto.com